

A  
**GROUND FLOOR PLAN**

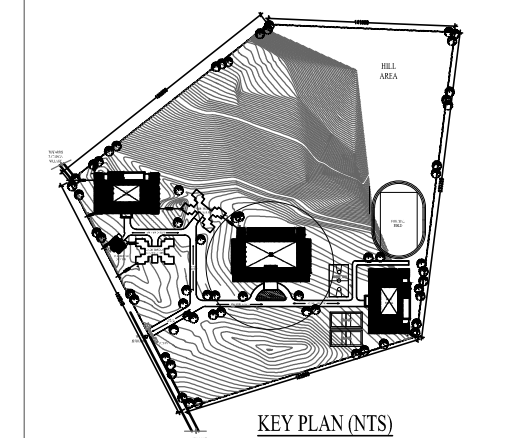
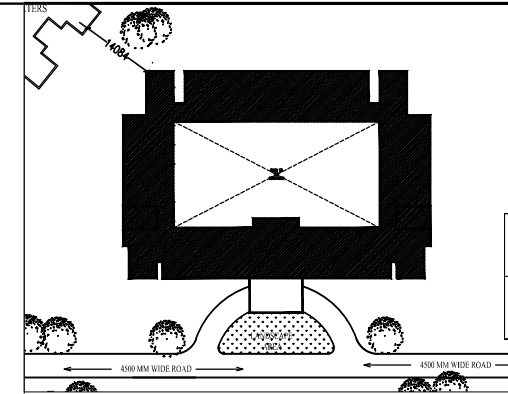

DOOR WINDOW SCHEDULE		
TYPE	SIZE	DESCRIPTION
D1	1050 X 2100	SINGLE PANELED FLUSH DOOR
D2	900 X 2100	SINGLE PANELED FLUSH DOOR
D3	750 X 2100	PVC DOOR
D4	1500 X 2100	DOUBLE PANELED FLUSH DOOR
D5	1050 X 2100	M.S. DOOR
W1	1200 X 1350	DOUBLE PANELED SLIDING WINDOW
W2	1800 X 1350	DOUBLE PANELED SLIDING WINDOW
V1	600 X 600	VENTILATOR
V2	600 X 1200	VENTILATOR

**AREA STATEMENT**

GROUND FLOOR AREA-	1473.00 SQ M (15855.37 SQ FT)
FIRST FLOOR AREA	-1452.00 SQ M (15629.37 SQ FT)
PORTICO AREA	-75.5 SQ M (807.2 SQ FT)
<b>TOTAL AREA</b>	<b>-3000.00 SQ M (3229194 SQ FT)</b>

\*NOTE:- DRAWINGS /VIEW ARE SUBJECT TO MODIFICATION AS PER ACTUAL SITE CONDITION

CATEGORY OF DRG.	TENDER DRAWING
ST & SC DEVELOPMENT DEPARTMENT GOVT. ODISHA	
CONSULTANT A+B INCORPORATION BREF COLONY NAYAPALLY, BBR	
EXECUTING AGENCY ENGINEERING PROJECTS (INDIA) LTD. (A GOVERNMENT OF INDIA ENTERPRISE)	
PACKAGE DESCRIPTION	EKALABYA MODEL RESIDENTIAL SCHOOL FOR ST AND SC DEVELOPMENT DEPARTMENT, GOVT. OF ODISHA AT NUAPADAR, KANDHAMAL

THIS DRAWING IS CONFIDENTIAL & SHOULD NOT BE DISCLOSED, COPIED OR LENT TO A THIRD PARTY WITHOUT WRITTEN CONSENT OF ENGINEERING PROJECTS (I) LTD. EXCEPT FOR THE PURPOSE OF CONSTRUCTION, OPERATION AND MAINTENANCE OF THE SYSTEM FOR WHICH THE DRAWING IS MEANT.

S.NO	DRG. NO.	TITLE	NO	DATE	DESCRIPTION	BY	APPD
REFERENCES					REVISIONS		

DESIGN	A+B INC	TITLE	ACADEMIC /ADMINISTRATIVE BLOCK (GROUND FLOOR PLAN)
DRAWN	A+B INC	SCALE	1:100
CHD	EPL	DR DOCUMENT NO.	
APPROVED	CLIENT	CONSULTANT DRAWING NO.	AB/EPL/EMRS/ARCH/002
DATE	30.8.2016		